



ADAPTOR FLANGES

CHECK VALVES

Adaptor flanges for manholes

- **Universal:** fits all circular manholes from DN 600 upwards.
- **Easy to install:** fixed in the manhole using mechanical or chemical anchors.
- **Highly resistant:** fibreglass-reinforced polyester or HDPE, EPDM flange joints.

ADAPTOR FLANGES

VALVES & CHECK VALVES



CONTENTS

INTRODUCTION	4
AREA OF USE	4
THE RANGE	4
TECHNICAL DATA	4
FLANGES FOR CHECK VALVES	5
AR_V_N AND AR_1000_N FLANGES	5
AR_V_B FLANGES	6
INSTALLATION	7
AR_V_N AND AR_1000_N FLANGES	7
FLANGES AR_V_B	7
OTHER NORHAM SOLUTIONS	8

ADAPTOR FLANGES

VALVES & CHECK VALVES



→ INTRODUCTION

AREA OF USE

The multi-hole **ADAPTATION FLANGE** provides a suitable and optimal solution when a flat or "female" surface part (such as a valve, regulator, etc.) has to be installed in a circular manhole.

Thanks to its design (patented system no. FR 1563030), a multi-hole **ADAPTATION FLANGE** can be installed in manholes of very different diameters (one product covers several manhole internal diameters).

Three standard ranges of multi-hole **ADAPTATION FLANGES** are available:

- ranges **AR_V_N** and **AR_1000_N** for end-of-pipe valves;
- range **AR_V_B** for flanged valves;

For all other types of elements to be installed, a customised design can be produced: please contact us.

→ THE RANGE

TECHNICAL DATA

	FLANGES FOR CHECK VALVES		
IMAGE			
RANGE	AR_V_N	AR_1000_N	AR_V_B
AREA OF USE	MULTITUBE MULTI N and ECO-FLAP® end-of-pipe valves		MULTITUBE MULTI NB or ECO-FLAP® flanged valves
BODY	Isophthalic gelcoat, glass fibre-reinforced isophthalic polyester resin		HDPE
FLANGE JOINT	EPDM		
ANCHORAGE	Mechanical (AISI 316 stainless steel)		
DN	From DN 200 to DN 400	DN 500 and DN 600	From DN 100 to DN 600
MANHOLE Ø	From 600 mm to 1500 mm	1 000 mm	From 600 mm to 8 000 mm
PAGE	5		6

ADAPTOR FLANGES

VALVES & CHECK VALVES

→ FLANGES FOR CHECK VALVES

AR_V_N AND AR_1000_N FLANGES

AREA OF USE

The AR_V_N and AR_1000_N ranges are designed for all NORHAM MULTI N and ECO-FLAP® check valves and for all other parts with "female" connections.

They are fixed to a circular wall using AISI 316 stainless steel screws; check valve is hold to the flange using a **NORHAM COUPLINGS**⁽¹⁾ (not included).



BARE FLANGE WITHOUT CHECK VALVE



MATERIAL

- **Body:** isophthalic gel-coat and glass fibre reinforced polyester resin;
- **Mechanical anchors:** AISI 316 stainless steel.
- **Flange joint:** EPDM;

AR_V_N RANGE FROM DN 200 TO DN 400

REF.	MANHOLE Ø ⁽²⁾	DN	A	B	L
AR_V_N_200	600 to 1 500	200	248	265	128
AR_V_N_250	800 to 1 500	250	285	330	125
AR_V_N_300	800 to 1 200	300	358	400	139
AR_V_N_400	800 to 1 200	400	500	460	158

AR_1000_N RANGE DN 500 AND DN 600

REF.	MANHOLE Ø ⁽²⁾	DN	A	B	L
AR_1000_N_500	1 000	500	670	620	230
AR_1000_N_600		600	780	725	

(2) For all other sizes, please contact us.

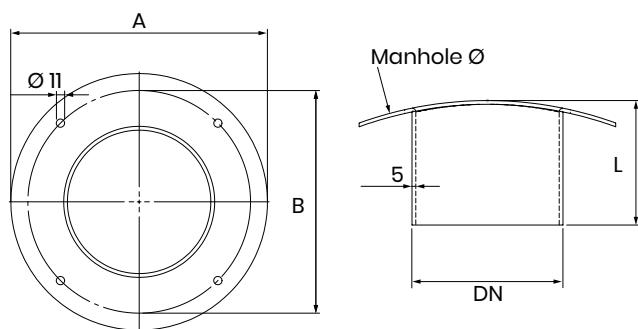

INSTALLATION EXAMPLE

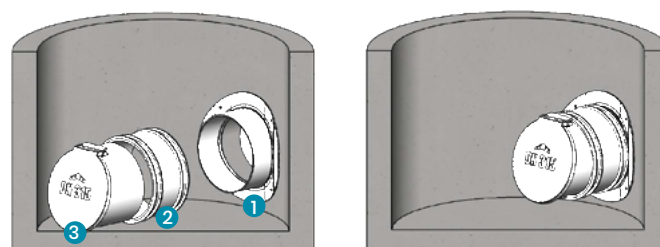

LEGEND:

- ① Adaptor flange. / ② Manhole NORHAM COUPLINGS.
- ③ NORHAM MULTI N end-of-pipe valve.

ADAPTOR FLANGES

VALVES & CHECK VALVES

AR_V_B FLANGES

AREA OF USE

The AR_V_B range is designed for all NORHAM MULTI NB and ECO-FLAP® check valves, as well as for all other ISO PN 10 flanged parts.

It is fixed to a circular wall using AISI 316 stainless steel screws.



BARE FLANGE WITHOUT CHECK VALVE

MATERIAL

- **Body:** HDPE;
- **Flange joint:** EPDM;
- **Mechanical anchors:** AISI 316 stainless steel.

AR_V_B RANGE FROM DN 100 TO DN 600

REF.	MANHOLE Ø ⁽¹⁾	DN	A	B	L
AR_V_B_100	600 to 1 600	100	220	180	30
AR_V_B_125	600 to 1 600	125	250	210	30
AR_V_B_150	600 to 1 600	150	285	240	30
AR_V_B_200	600 to 1 500	200	340	295	55
AR_V_B_250	800 to 1 500	250	395	350	53
AR_V_B_300	800 to 1 200	300	455	400	74
AR_V_B_400	800 to 1 200	400	565	515	116
AR_V_B_500-2	1 500 to 2 000	500	670	620	75
AR_V_B_600-3	5 000 to 8 000	600	780	725	27

(1) For all other sizes, please contact us.

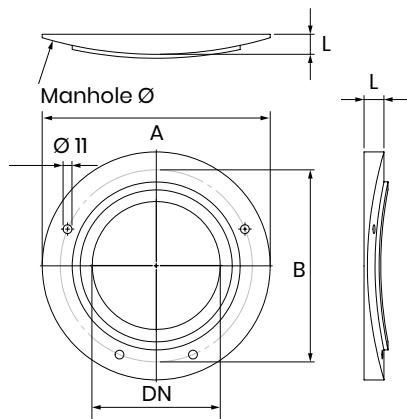

INSTALLATION EXAMPLE

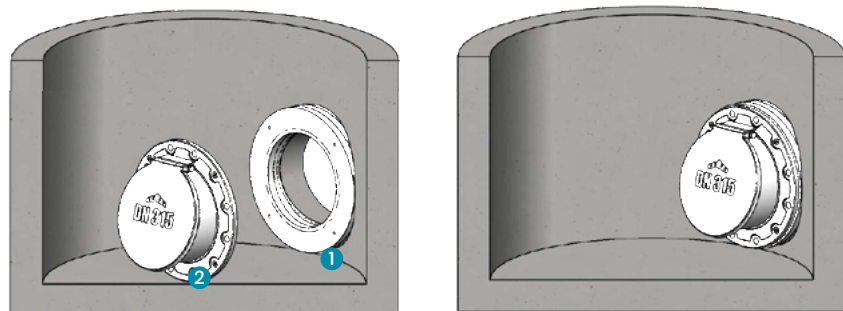

LEGEND:

- ① Adaptor flange. / ② NORHAM MULTI NB flange valves.

ADAPTOR FLANGES

VALVES & CHECK VALVES

→ INSTALLATION

Before any installation and for each range of flanges, check that the manhole is in perfect condition. Its surface must be clean, smooth, and free of bumps, particularly in area where adaptor flange will be fitted
Check the general condition of the adaptor plate and the seals inside of the flange.

AR_V_N AND AR_1000_N FLANGES

PHASE 1	Position the adaptor plate perfectly on the manhole, level with the pipe.
PHASE 2	Mark the four fixing points on the concrete support. Remove the adaptor plate.
PHASE 3	Drill holes in the concrete base (\varnothing 8 mm, depth 60 mm) and blow out holes.
PHASE 4	Insert throughbolts into holes and hammer them in, if necessary, leaving only two or three threads beyond the part to be fixed.
PHASE 5	Tighten all the fasteners alternately until you reach 50% of the set minimum torque. Then tighten all the fasteners to the minimum required torque (20 Nm).

DRILLING LOCATIONS

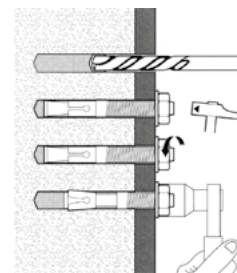
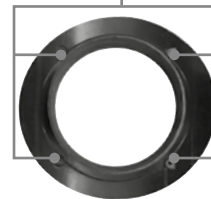

AR_V_B FLANGES

PHASE 1	Position the adaptor plate perfectly on the manhole, level with the pipe.
PHASE 2	Mark the four fixing points on the concrete support. Remove the adaptor plate.
PHASE 3	Drill holes in the concrete base (\varnothing 8 mm, depth 52 mm) and blow out holes.
PHASE 4	Insert the throughbolts into the fixing holes.
PHASE 5	Position the adaptor flange and check valve.
PHASE 6	Tighten evenly with a torque to 20 Nm.

DRILLING LOCATIONS

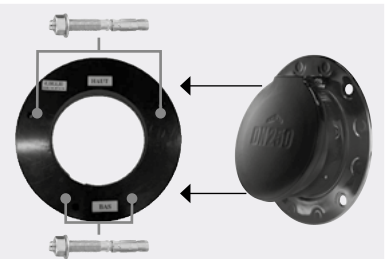
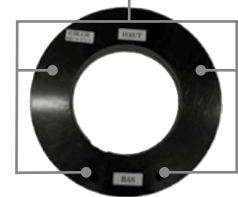

ADAPTOR FLANGES

VALVES & CHECK VALVES



→ OTHER NORHAM SOLUTIONS

ECO-FLAP®



Preventive anti-backflow solution for domestic networks



DOWNLOAD THE DOCUMENTATION

MULTITUBE



Anti-return check valves for rainwater and sanitation networks.



DOWNLOAD THE DOCUMENTATION



NORHAM

ZA DRUISIEUX — 26260 SAINT DONAT SUR L'HERBASSE - FRANCE

TEL: 33 (0) 4 75 45 00 00 - norham@norham.fr

www.norham.fr



www.norham.fr